



PTZ100

COMPACT PTZ CAMERA SYSTEM

ahlbergs.staging.westart.se/products/cameras/ptz100



The PTZ100 is a compact HD color camera equipped with integrated pan-and-tilt functionality and powerful lighting, making it ideal for overview inspections during outages reactor tank and spent fuel pool services. With its 10x optical and 32x digital zoom, the PTZ100 delivers clear, detailed imaging to support safe and efficient operations.

MORE INFORMATION ABOUT PTZ100

APPLICATIONS

- Ideal for low-radiation inspections of reactor vessel components and internal reactor parts
- For surveillance during outage service work

BENEFITS

- Compact system
- Extensiv zoom
- Auto-focus and auto-iris
- Remotely controlled LED intensity
- Can be controlled by Ahlberg CCU100

SPECIFICATIONS

PHYSICAL CHARACTERISTICS

Width	123 mm
Height	277 mm
Weight	4.4 kg
Housing material	Stainless steel EN 1.4301/EN 1.4436, AISI 304/AISI 316
Front glass material	Polycarbonate

OPTICAL FEATURES

Resolution SD	700 TV-lines
Zoom	x10 optical zoom, x32 digital zoom
SD horizontal angle of view	~5°-54°

MECHANICAL FEATURES

Pan Angle	±180°
Tilt Angle	±90° (from the vertical plane)

ENVIRONMENTAL TOLERANCES

Radiation Tolerance (dose rate)	50 Gy/h (5 000 rad/h)
Radiation Tolerance (total dose)	3.5 bar

We reserve the right to alter specifications without prior notice

Maximum Operating Temperature	50°C (short-term up to 70°C) 122°F (short-term up to 158°F)
-------------------------------------	---

Water Tightness

LIGHTING FEATURES

Type	2 Ahl-Light 1
Output	1800 lumen

We reserve the right to alter specifications without prior notice

PTZ100 IMAGES

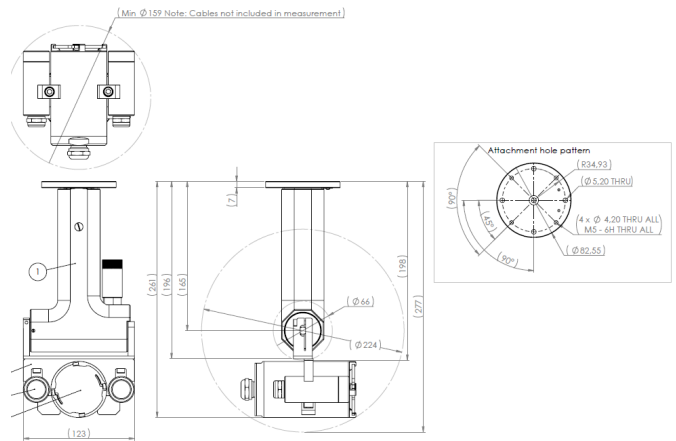

We reserve the right to alter specifications without prior notice